

# City of Cannon Beach Tree Removal Application

Please fill out this form completely. Please type or print.

**Applicant Name:** \_\_\_\_\_

Mailing Address: \_\_\_\_\_

Phone: \_\_\_\_\_ Email: \_\_\_\_\_

**Property Owner Name:** \_\_\_\_\_

Mailing Address: \_\_\_\_\_

Phone: \_\_\_\_\_ Email: \_\_\_\_\_

**Property Location:** \_\_\_\_\_ **Map/Tax Lot Number:** \_\_\_\_\_

**The city shall issue a tree removal permit if one of the following criteria is met. Please circle the letter of the criteria that applies.**

These criteria require a Tree Removal Report from an International Society of Arboriculture (ISA) Certified Arborist:

- A. You are constructing a structure or development approved and allowed by pursuant to Cannon Beach Municipal Code 17.70.030, which involves any form of ground disturbance; including required vehicular and utility access. **SEE ATTACHMENT A – Removing Trees Because of Construction.**
- B. Removal of a tree for the health and vigor of surrounding trees.

These criteria require an ISA Tree Hazard Evaluation Form prepared by an ISA Certified Arborist:

- C. The tree presents a safety hazard, where:
  - 1. The condition or location of the tree presents either a foreseeable danger to public safety, or a foreseeable danger of property damage to an existing structure; and,
  - 2. Such hazard or danger cannot reasonably be alleviated by pruning or treatment of the tree.
- D. The tree was damaged by storm, fire or other injury, which cannot be saved by pruning.

You must submit a tree removal permit with a reason if:

- E. The tree is dead.
- F. Tree removal is necessary to provide solar access to a solar energy system where pruning will not provide adequate solar access:
  - 1. The city may require documentation that a device qualifies for Oregon Department of Energy Solar Tax Credit, or other incentive for installation of solar devices offered by a utility.
  - 2. No tree measuring more than 24 inches in diameter shall be removed for solar access.
- G. Tree removal is for landscaping purposes, subject to the following conditions:
  - 1. The tree cannot exceed 10 inches in diameter.
  - 2. A landscape plan for the affected area must be submitted and approved by the City.
  - 3. The landscape plan must incorporate replacement trees for the trees removed. The replacement trees must be at least six feet in height or have a two-inch caliper; and ,
  - 4. The City shall inspect the property one year after the approval of the permit to insure the landscape plan has been implemented.

**If your tree presents an immediate danger of collapse** and if such potential collapse represents a clear and present hazard to persons or property, **please contact the Community Development Director (CDD)**. If it is determined by the CDD that there is an immediate danger, then a tree removal permit is not required prior to tree removal. However, within seven days after the tree removal, the tree owner shall make application for an after-the-fact permit. Where a tree presents an immediate danger of collapse, a complete ISA Tree Hazard Evaluation Form prepared by a certified arborist is not required. Where a safety hazard exists, as defined by this subsection, the city may require the tree's removal. If the tree has not been removed after forty-eight hours, the city may remove the tree and charge the costs to the owner.

Attach a site plan showing the location and type of all trees on the property, including the trees to be removed. Indicate the location of replacement trees and the type. SEE ATTACHMENT B – Site Plan. Attach photos of the trees to be removed and mark the trees with ribbon.

Explain how the request meets one or more of the applicable criteria. Include the number and type of trees requested for removal. If appropriate, explain why pruning would not accomplish the same goal as tree removal.



Application fee: \$50.00 for 1-4 trees; \$100 for 5 or more trees

**Note:** The application fee is a **nonrefundable** fee that is due upon receipt of application, whether the removal request is approved or denied.

Applicant Signature \_\_\_\_\_ Date: \_\_\_\_\_

If the applicant is other than the owner, the owner hereby grants permission for the applicant to act in their behalf.

Property Owner Signature: \_\_\_\_\_ Date: \_\_\_\_\_

Please attach the name, address, phone number and signature of any additional property owners.

I understand, as property owner, that I am responsible if an approved tree removal permit is violated in any way. As property owner, my signature or an authorized applicant's signature, allows any duly authorized employee of the City to enter upon all properties affected by this permit, for the purpose of follow-up inspection, observation or measurement.

\*\*\*\*\*

Date: \_\_\_\_\_ Fee Paid: \$ \_\_\_\_\_ Receipt Number: \_\_\_\_\_ Permit #: \_\_\_\_\_

Application is:

\_\_\_\_\_ Approved \_\_\_\_\_ Denied

\_\_\_\_\_ Approved - Tree replacement required per Cannon Beach Municipal Code 17.70.040, Tree Replacement Policy.

\_\_\_\_\_ Approved with comments:

By: \_\_\_\_\_ Date: \_\_\_\_\_

Decisions on the issuance of a tree removal permit may be appealed to the Planning Commission in accordance with Section 17.88.140 a, of the Municipal Code.

## **ATTACHMENT A**

### **Removing Trees Because of Construction**

If you are constructing a structure or development which involves any kind of ground disturbance; including required vehicular or utility access, prior to beginning construction, you must:

- 1) Contact a certified arborist
- 2) If the certified arborist determines that no trees will be affected by the proposed construction, then the certified arborist should write a letter stating these findings. **NOTE:** The City reserves the right to have the City Arborist review all arborist recommendations and make an independent report for administrative review. All administrative decisions may be appealed.
- 3) If the certified arborist determines that trees will be affected,
  - a. A site plan must be submitted with a Tree Removal permit. The Site Plan should indicate the location of all trees over 6" DBH on the subject property or off-site (in the adjoining right-of-way or on adjacent property) whose root structure might be impacted by excavation associated with the proposed structure, or by soil compaction caused by vehicular traffic or storage of materials.
  - b. Measures must be taken to avoid damaging trees not proposed for removal, both on the subject property and off-site (in the adjoining right-of-way or on adjacent property).
  - c. The area where a tree's root structure might be impacted by excavation, or where soil compaction caused by vehicular traffic or storage of materials might affect a tree's health, shall be known as a Tree Protection Zone (TPZ).
  - d. Prior to construction the TPZ shall be delineated by hi-visibility fencing a minimum of 3.5 feet tall, which shall be retained in place until completion of construction. Vehicular traffic, excavation and storage of materials shall be prohibited within the TPZ.

**The city may require the replanting of trees to replace those being removed. Tree replacements shall be in accordance with Cannon Beach Municipal Code 17.70.040 Tree replacement policy.**

1. When a replacement tree is required, at least **one tree from the native tree list** will have to be replanted. The following trees are considered native: Sitka spruce; Western hemlock; Douglas fir; Western red cedar; Red alder; Mountain ash; Big leaf maple; Vine maple.
2. The replacement trees shall be planted so that they **do not create future problems** in terms of solar access, view protection, building maintenance, or the survivability of other trees. Trees should generally **not be planted within five feet of the property line** and should not cause future issues with existing utilities, e.g., water line, sewer lateral, gas main-power.
3. The replacement trees shall be **at least six feet in height** at the time of planting.

## ATTACHMENT B SITE PLAN EXAMPLE FOR A TREE REMOVAL APPLICATION

A site plan is required as part of your tree removal request. The site plan should be on an 8.5" x 11" size paper, or larger and include the following information.

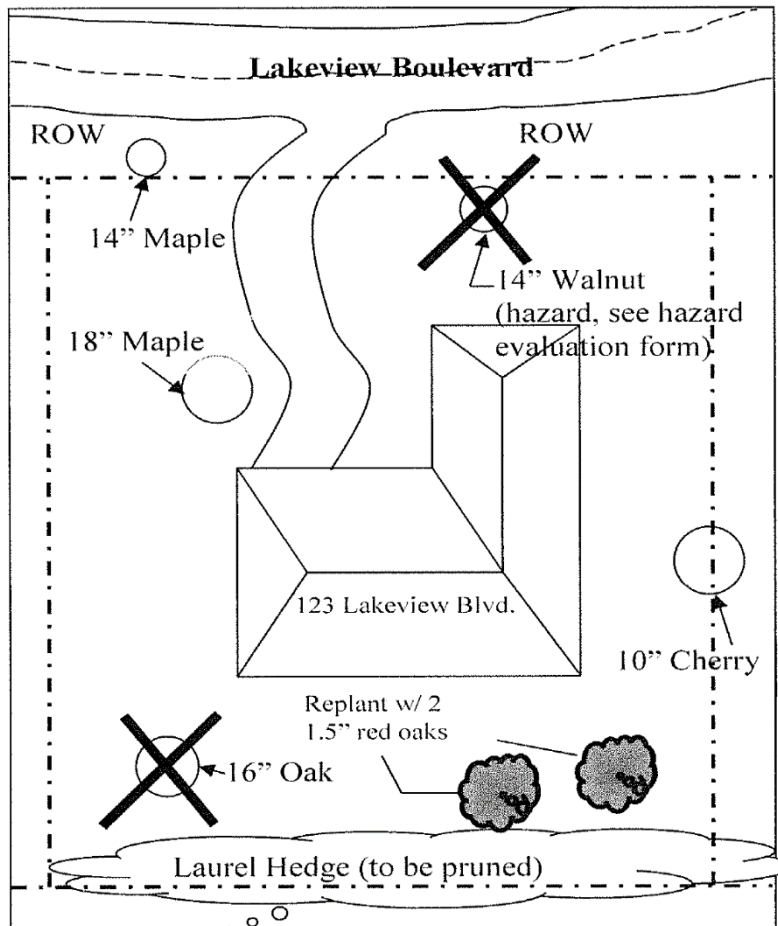

### Items to include on your Site Plan:

- Address of the Tree Removal Site;
- Property lines;
- Public Right of Way, including the name of any streets;
- Existing or proposed structures;
- Creeks, Streams, or any other natural features;
- Location of any existing 6" or larger tree, as measured from breast height (approximately 4' from the ground), with diameter size and type of tree;
- Please indicate by clearly marking those proposed for removal with an "X"

Within 24 Hours of submitting your application, mark the tree(s) with yellow ribbon.