

City of Cannon Beach Tree Removal Application

Please fill out this form completely. Please type or print.

Applicant Name: Todd Rowley

Mailing Address: PO Box 754 Cannon Beach

Phone: 503 440 7020 Email: jtoddrowley@msn.com

Property Owner Name: Cliff Lewis

Mailing Address: PO Box 1095 Cannon Beach

Phone: 503 436 2718 Email: _____

Property Location: 1660 Poplar Map/Tax Lot Number: 51029CB01315

The city shall issue a tree removal permit if one of the following criteria is met. Please circle the letter of the criteria that applies.

These criteria require a Tree Removal Report from an International Society of Arboriculture (ISA) Certified Arborist:

- A. You are constructing a structure or development approved and allowed by pursuant to Cannon Beach Municipal Code 17.70.030, which involves any form of ground disturbance; including required vehicular and utility access. **SEE ATTACHMENT A – Removing Trees Because of Construction.**
- B. Removal of a tree for the health and vigor of surrounding trees.

These criteria require an ISA Tree Hazard Evaluation Form prepared by an ISA Certified Arborist:

- ☒ C. The tree presents a safety hazard, where:
 - ☒ 1. The condition or location of the tree presents either a foreseeable danger to public safety, or a foreseeable danger of property damage to an existing structure; and,
 - ☒ 2. Such hazard or danger cannot reasonably be alleviated by pruning or treatment of the tree.
- ☒ D. The tree was damaged by storm, fire or other injury, which cannot be saved by pruning.

You must submit a tree removal permit with a reason if:

- E. The tree is dead.
- F. Tree removal is necessary to provide solar access to a solar energy system where pruning will not provide adequate solar access:
 - 1. The city may require documentation that a device qualifies for Oregon Department of Energy Solar Tax Credit, or other incentive for installation of solar devices offered by a utility.
 - 2. No tree measuring more than 24 inches in diameter shall be removed for solar access.
- G. Tree removal is for landscaping purposes, subject to the following conditions:
 - 1. The tree cannot exceed 10 inches in diameter.
 - 2. A landscape plan for the affected area must be submitted and approved by the City.
 - 3. The landscape plan must incorporate replacement trees for the trees removed. The replacement trees must be at least six feet in height or have a two-inch caliper; and,
 - 4. The City shall inspect the property one year after the approval of the permit to insure the landscape plan has been implemented.

If your tree presents an immediate danger of collapse and if such potential collapse represents a clear and present hazard to persons or property, please contact the Community Development Director (CDD). If it is determined by the CDD that there is an immediate danger, then a tree removal permit is not required prior to tree removal. However, within seven days after the tree removal, the tree owner shall make application for an after-the-fact permit. Where a tree presents an immediate danger of collapse, a complete ISA Tree Hazard Evaluation Form prepared by a certified arborist is not required. Where a safety hazard exists, as defined by this subsection, the city may require the tree's removal. If the tree has not been removed after forty-eight hours, the city may remove the tree and charge the costs to the owner.

City of Cannon Beach
Finance Department

Last edited 9/8/2021

FEB 10 2023

Received

Attach a site plan showing the location and type of all trees on the property, including the trees to be removed. Indicate the location of replacement trees and the type. SEE ATTACHMENT B – Site Plan. Attach photos of the trees to be removed and mark the trees with ribbon.

Explain how the request meets one or more of the applicable criteria. Include the number and type of trees requested for removal. If appropriate, explain why pruning would not accomplish the same goal as tree removal.

.....

Application fee: \$50.00 for 1-4 trees; \$100 for 5 or more trees

Note: The application fee is a **nonrefundable** fee that is due upon receipt of application, whether the removal request is approved or denied.

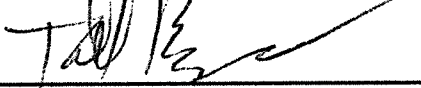
Applicant Signature  Date: Feb 6 2023

If the applicant is other than the owner, the owner hereby grants permission for the applicant to act in their behalf.

Property Owner Signature:  Date: 2-9-23

Please attach the name, address, phone number and signature of any additional property owners.

I understand, as property owner, that I am responsible if an approved tree removal permit is violated in any way. As property owner, my signature or an authorized applicant's signature, allows any duly authorized employee of the City to enter upon all properties affected by this permit, for the purpose of follow-up inspection, observation or measurement.

Date: 2/10/23 Fee Paid: \$ 50 Receipt Number: _____ Permit #: _____

Application is:

X Approved _____ Denied

_____ Approved - Tree replacement required per Cannon Beach Municipal Code 17.70.040, Tree Replacement Policy.

City of Cannon Beach
Finance Department

_____ Approved with comments:

FEB 10 2023

PAID

By:  Robert St. Clair
Planner Date: March 15, 2023

Decisions on the issuance of a tree removal permit may be appealed to the Planning Commission in accordance with Section 17.88.140 a, of the Municipal Code.



A Photographic Guide to the Evaluation of Hazard Trees in Urban Areas

TREE HAZARD EVALUATION FORM 2nd Edition

Site/Address: 1600 POPLAR ST. CANNON BEACH

Map/Location: _____

Owner: public _____ private ☒ unknown _____ other _____

Date: 1-3-23 Arborist: BALDEN ISA#: PN0736

Arborist's Signature: [Signature]

HAZARD RATING:

2 + 3 + 4 = 9
Failure Potential + Size of part + Target Rating = Hazard Rating
☒ Immediate action needed
Needs further inspection
Dead tree

TREE CHARACTERISTICS

Tree #: 1 Species: ALNUS RUBRA (RED ALDER)
DBH: 18 # of trunks: 1 Height: _____ Spread: _____
Form: ☐ generally symmetric ☐ minor asymmetry ☒ major asymmetry ☐ stump sprout ☐ stag-headed
Crown Class: ☐ dominant ☐ co-dominant ☒ intermediate ☐ suppressed
Live crown ratio: _____ % Age Class: ☐ young ☐ semi-mature ☒ mature ☐ over-mature/senescent
Pruning History: ☐ crown cleaned ☐ excessively thinned ☐ topped ☐ crown raised ☐ pollarded ☐ crown reduced ☐ flush cuts ☐ cabled/braced
☒ none ☐ multiple pruning events Approx. dates: _____
Special Value: ☐ specimen ☐ heritage/historic ☐ wildlife ☐ unusual ☐ street tree ☐ screen ☐ shade ☐ indigenous ☐ protected by gov. agency

TREE HEALTH

Foliage Cover: ☐ normal ☐ chronic ☐ necrotic Epicormics? Y N
Foliage Density: ☐ normal ☐ sparse Leaf size: ☐ normal ☐ small
Annual shoot growth: ☐ excellent ☐ average ☐ poor Twig Dieback? Y N
Woundwood development: ☐ excellent ☐ average ☐ poor ☐ none
Vigor class: ☐ excellent ☐ average ☐ fair ☐ poor
Major pests/diseases: _____
Growth obstructions:
☐ stakes ☐ wire/ties ☐ signs ☐ cables
☐ curb/pavement ☐ guards
☐ other _____

SITE CONDITIONS

Site Character: ☒ residence ☐ commercial ☐ industrial ☐ park ☐ open space ☐ natural ☐ woodland/forest
Landscape type: ☐ parkway ☐ raised bed ☐ container ☐ mound ☐ lawn ☒ shrub border ☐ wind break
Irrigation: ☒ none ☐ adequate ☐ inadequate ☐ excessive ☐ trunk wetted
Recent site disturbance? Y ☒ N ☐ construction ☐ soil disturbance ☐ grade change ☐ line clearing ☐ site clearing
% dripline paved: 0% 10-25% 25-50% 50-75% 75-100% Pavement lifted? Y N
% dripline w/fill soil: 0% 10-25% 25-50% 50-75% 75-100%
% dripline grade lowered: 0% 10-25% 25-50% 50-75% 75-100%
Soil problems: ☐ drainage ☐ shallow ☐ compacted ☐ droughty ☐ saline ☐ alkaline ☐ acidic ☐ small volume ☐ disease center ☐ history of fail
☐ clay ☐ expansive ☐ slope _____? aspect: _____
Obstructions: ☐ lights ☐ signage ☐ line-of-site ☐ view ☐ overhead lines ☐ underground utilities ☐ traffic ☒ adjacent veg. ☐ _____
Exposure to wind: ☐ single tree ☐ below canopy ☐ above canopy ☐ recently exposed ☐ windward, canopy edge ☒ area prone to windthrow
Prevailing wind direction: SW Occurrence of snow/ice storms ☐ never ☐ seldom ☐ regularly

TARGET

Use Under Tree: ☒ building ☒ parking ☐ traffic ☒ pedestrian ☐ recreation ☒ landscape ☐ hardscape ☐ small features ☐ utility lines
Can target be moved? Y ☒ N ☐ Can use be restricted? Y ☒ N ☐
Occupancy: ☐ occasional use ☐ intermittent use ☐ frequent use ☒ constant use

TREE DEFECTS

ROOT DEFECTS:

Suspect root rot: Y N Mushroom/conk/bracket present: Y N ID: _____
 Exposed roots: ☐ severe ☐ moderate ☐ low Undrained: ☐ severe ☐ moderate ☐ low
 Root pruned: _____ Root area affected: _____% Buttress wounded: Y N When: _____
 Restricted root area: ☐ severe ☐ moderate ☐ low Potential for root failure: ☐ severe ☐ moderate ☐ low
 LEAN: 30 deg. From vertical ☐ natural ☒ unnatural ☐ self-corrected Soil heaving: Y N
 Decay in plane of lean: Y N Roots broken: Y N Soil cracking: Y N
 Compounding factors: _____ Lean severity: ☐ severe ☐ moderate ☐ low

CROWN DEFECTS: Indicate presence of individual defects and rate their severity (s=severe, m=moderate, l=low)

| DEFECT | ROOT CROWN | TRUNK | SCAFFOLDS | BRANCHES |
|-------------------------|------------|-------|-----------|----------|
| Poor taper | | | | |
| Bow, sweep | | | | |
| Codominants/forks | | | | |
| Multiple attachments | | | | |
| Included bark | | | | |
| Excessive end weight | | ✓ S | ✓ S | |
| Cracks/splits | | | | |
| Hangers | | | | |
| Girdling | | | | |
| Wounds/seam | | | | |
| Decay | | | | |
| Cavity | | | | |
| Conks/mushrooms/bracket | | | | |
| Bleeding/sap flow | | | | |
| Loose/cracked bark | | | | |
| Nesting hold/bee hive | | | | |
| Deadwood/stubs | | | | |
| Borers/termites/ants | | | | |
| Cankers/galls/burrs | | | | |
| Previous failure | | | | |

HAZARD RATING

Tree part most likely to fail: ENTIRE TREE
 Inspection period: _____ annual _____ biannual _____ other _____
 Failure Potential + Size of Part + Target Rating = Hazard Rating
2 + 3 + 4 = 9

Failure potential: 1-low; 2-medium; 3-high; 4-severe
 Size of part: 1 - <6" (15 cm); 2 - 6-18" (15-45 cm);
 3 - 18-30" (45-75 cm); 4 - > 30" (75 cm)
 Target rating: 1 - occasional use; 2 - intermittent use;
 3 - frequent use; 4 - constant use

HAZARD ABATEMENT

Prune: ☐ remove defective part ☐ reduce end weight ☐ crown clean ☐ thin ☐ raise canopy ☐ crown reduce ☐ restructure ☐ shape
 Cable/Brace: _____ Inspect further: ☐ root crown ☐ decay ☐ aerial ☐ monitor
 Remove tree: Y N Replace? Y N Move Target: Y N Other: _____
 Effect on adjacent trees: ☒ none ☐ evaluate
 Notification: ☒ owner ☐ manager ☐ governing agency Date: 1-5-2023

COMMENTS

TREE GROWTH DIRECTED BY SUPPRESSION OF ADJACENT
 SPRUCE. EXCESSIVE END WEIGHT. PLUS AREA OF
 TREE FAILURES IN STORM CONDITIONS REASON FOR
 REMOVAL.

Balden Arboriculture Services
41500 Anderson Road
Nehalem, OR 97131
503-801-3762

TREE LOCATION SITE DIAGRAM

Client: ROWLEY
1600 POPLAR ST.
Date: CANNON BEACH
1-5-2023
Project: TREE REMOVAL

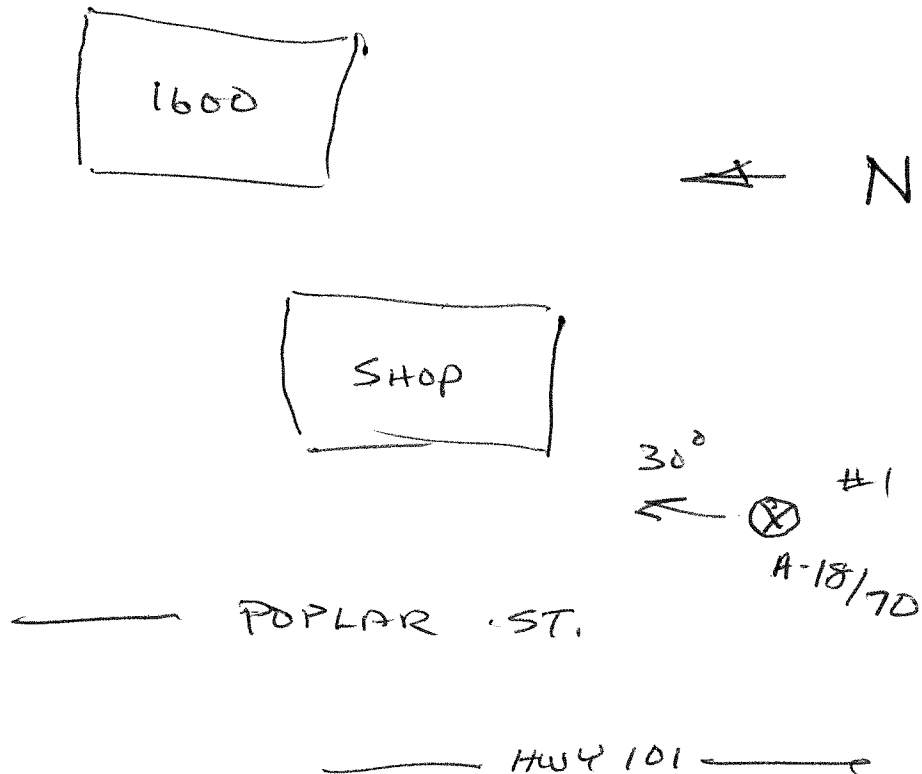

LEGEND

Tree # 1

Species ALDER

Size (DBH) 18"

Recommendations

PER REPORT

Sketch not to scale



Treescaping Northwest
Jeff Gerhardt, Consulting Arborist
ISA Certified Arborist #PN-5541A



City of Cannon Beach, Planning Department

Attn: Robert St. Clair
stclair@ci.cannon-beach.or.us
(503) 436-8041

March 15, 2023

Tree Removal Permit Application Review - 1660 Poplar

Per your request, I reviewed the Tree Removal Permit Application submitted by Todd Rowley. An ISA Tree Hazard Evaluation Form for 1 tree and site map, was included in the application from Certified Arborist, Joe Balden. I visually inspected the tree and site on February 14th. It is my recommendation the removal request for the tree be granted.

The tree is a red alder (*Alnus rubra*), and is approximately 20" in DBH and 60' tall (photograph attached). The tree has an extreme lean and presents a hazard to people and property. The tree has reached maturity and pruning or other remedial methods would not adequately reduce the risk. I recommend the removal request for this tree be granted according to permit Criteria C, "*The tree presents a safety hazard*".

Replanting does not look to be a stipulation for this property as several other trees are present onsite. I recommend removing ivy from the base of as many trees as possible in the area to prevent canopy constriction.

Best regards,

A handwritten signature in black ink, appearing to read "Jeff Gerhardt", written over a light pink rectangular background.

Jeff Gerhardt

Treescaping Northwest
P.O. Box 52
Manzanita, OR 97130

CCB# 236534
Cell: 503-453-5571
www.treescapingnorthwest.com

Heavily leaning alder and ivy infestation



Treescaping Northwest
P.O. Box 52
Manzanita, OR 97130

CCB# 236534
Cell: 503-453-5571
www.treescapingnorthwest.com