

1860 Pacific St, Cannon Beach OR  
Account 53172



[Property Details](#) [Improvements](#) [Assessments](#) [Sales History](#) [Taxes](#) [Payments](#) [Documents](#)

## General Information

Property Address 1860 Pacific St, Cannon Beach OR

Legal Description Metes & Bounds

Account ID 53172

Tax Map Key [51030DD08300](#)

Size in Acres 0.13

Property Status Active

Property Type Real Property  
Residential  
Improved Residential Land

## Owner Information

Owner Name Christianson Jeffrey A

Mailing Address 5504 Lakeview Dr #B  
Kirkland WA 98033

→ [Request Change of Address](#)

→ [Sign up for e-Statements](#)

Sept 18, 2020 Sale  
\$ 2,500,000!  
Incl. 202008122



Year	Land Value	Improvements Value	Real Market Value	Assessed Value
2020	\$1,283,179.00	\$335,458.00	\$1,618,637.00	\$1,041,976.00
2019	\$1,270,474.00	\$334,420.00	\$1,604,894.00	\$1,011,628.00
2018	\$1,198,561.00	\$317,683.00	\$1,516,244.00	\$982,164.00
2017	\$1,141,487.00	\$304,607.00	\$1,446,094.00	\$953,558.00
2016	\$1,164,783.00	\$312,917.00	\$1,477,700.00	\$925,785.00
2015	\$1,039,985.00	\$281,260.00	\$1,321,245.00	\$898,821.00
2014	\$705,983.00	\$685,346.00	\$1,391,329.00	\$860,835.00
2013	\$705,982.00	\$639,569.00	\$1,345,551.00	\$835,763.00
2012	\$820,910.00	\$466,839.00	\$1,287,749.00	\$811,421.00
2011	\$820,910.00	\$466,839.00	\$1,287,749.00	\$787,788.00
2010	\$1,013,469.00	\$401,080.00	\$1,414,549.00	\$764,843.00
2009	\$1,192,317.00	\$818,532.00	\$2,010,849.00	\$742,567.00
2008	\$1,135,540.00	\$843,848.00	\$1,979,388.00	\$720,940.00
2007	\$1,013,874.00	\$753,434.00	\$1,767,308.00	\$699,942.00
2006	\$719,059.00	\$534,351.00	\$1,253,410.00	\$679,556.00
2005	\$665,791.00	\$493,898.00	\$1,159,689.00	\$659,764.00
2004	\$594,457.00	\$368,581.00	\$963,038.00	\$640,548.00
2003	\$577,143.00	\$247,370.00	\$824,513.00	\$621,892.00

Sales Date	Instrument ID	Sale Amount
September 18, 2020	202008122	\$2,500,000.00

<b>Tax Year</b>	<b>Total Billed</b>	<b>Interest</b>	<b>Discount</b>	<b>Total Due</b>
<a href="#">2020</a>	\$12,538.00	\$0.00	\$-376.14	\$12,161.86
<a href="#">2019</a>	\$11,784.55	\$0.00	\$0.00	\$0.00
<a href="#">2018</a>	\$11,166.31	\$0.00	\$0.00	\$0.00
<a href="#">2017</a>	\$10,732.13	\$0.00	\$0.00	\$0.00
<a href="#">2016</a>	\$9,230.45	\$0.00	\$0.00	\$0.00
<a href="#">2015</a>	\$8,861.56	\$0.00	\$0.00	\$0.00
<a href="#">2014</a>	\$8,459.35	\$0.00	\$0.00	\$0.00
<a href="#">2013</a>	\$8,209.60	\$0.00	\$0.00	\$0.00
<a href="#">2012</a>	\$8,334.92	\$0.00	\$0.00	\$0.00
<a href="#">2011</a>	\$8,264.68	\$0.00	\$0.00	\$0.00
<a href="#">2010</a>	\$7,963.22	\$0.00	\$0.00	\$0.00
<a href="#">2009</a>	\$7,805.50	\$0.00	\$0.00	\$0.00
<a href="#">2008</a>	\$7,553.36	\$0.00	\$0.00	\$0.00
<a href="#">2007</a>	\$7,367.14	\$0.00	\$0.00	\$0.00
<a href="#">2006</a>	\$7,184.27	\$0.00	\$0.00	\$0.00
<a href="#">2005</a>	\$6,933.53	\$0.00	\$0.00	\$0.00
2004	\$6,556.59	\$0.00	\$0.00	\$0.00
2003	\$6,307.54	\$0.00	\$0.00	\$0.00

[View Your Current Statement](#)

## Total Taxes Due as of November 5, 2020

Current Year Due	\$12,161.86
Past Year Due	\$0.00
<b>Total Due</b>	<b>\$12,161.86</b>

By clicking "Pay Your Bill" below, you agree that you have read our [Important Notes](#) regarding fees.

[Pay Your Bill](#)

<b>Tax Year</b>	<b>Receipt No</b>	<b>Date Posted</b>	<b>Amount Paid</b>
2019	615398	November 15, 2019	\$11,431.01
2018	589213	October 18, 2018	\$10,831.32
2017	569687	October 27, 2017	\$10,410.17
2016	548981	October 20, 2016	\$8,953.54
2015	527970	October 22, 2015	\$8,595.71
2014	506151	October 23, 2014	\$8,205.57
2013	480657	October 16, 2013	\$7,963.31
2012	459273	October 24, 2012	\$8,084.87
2011	437415	November 3, 2011	\$8,016.74
2010	410011	October 19, 2010	\$7,724.32
2009	385216	October 20, 2009	\$7,571.34
2008	361490	October 20, 2008	\$7,326.76
2007	329776	October 26, 2007	\$7,146.13
2006	300962	November 3, 2006	\$6,968.74
2005	266951	November 1, 2005	\$6,725.52
2004	226279	October 28, 2004	\$196.70
2004	221700	October 13, 2004	\$6,556.59
2003	201382	November 17, 2003	\$6,118.31

 [Annual Appraisal Report](#)

 [Current Statement](#)

©2020 Clatsop County, Oregon

Data accurate as of November 5, 2020 02:22PM Every effort has been made to offer the most current and correct information possible on these pages. The information included on these pages has been compiled by County staff from a variety of sources, and is subject to change without notice. Clatsop County makes no warranties or representations whatsoever regarding the quality, content, completeness, accuracy or adequacy of such information and data. Clatsop County reserves the right to make changes at any time without notice. Original records may differ from the information on these pages. Interest and discounts, if available, may not be accurately reflected here. Verification of information on source documents is recommended. By using this application, you assume all risks arising out of or associated with access to these pages, including but not limited to risks of damage to your computer, peripherals, software and data from any virus, software, file or other cause associated with access to this application. Clatsop County shall not be liable for any damages whatsoever arising out of any cause relating to use of this application, including but not limited to mistakes, omissions, deletions, errors, or defects in any information contained in these pages, or any failure to receive or delay in receiving information.

# 1858 Pacific St, Cannon Beach OR

Account 53170



[Property Details](#) [Improvements](#) [Assessments](#) [Sales History](#) [Taxes](#) [Payments](#) [Documents](#)

## General Information

Property Address  1858 Pacific St, Cannon Beach OR

Legal Description  Elk Creek Beach No. 1 10 13

Account ID  53170

Tax Map Key  [51030DD08200](#)

Size in Acres  0.15

Property Status  Active

Property Type  Real Property  
Residential  
Improved Residential Land

## Owner Information

Owner Name  Avatara LLC

Mailing Address  14116 NW Harbor Ln  
Portland OR 97229

→ [Request Change of Address](#)

→ [Sign up for e-Statements](#)



Year	Land Value	Improvements Value	Real Market Value	Assessed Value
2020	\$1,309,091.00	\$478,294.00	\$1,787,385.00	\$1,144,452.00
2019	\$1,296,128.00	\$476,548.00	\$1,772,676.00	\$1,111,120.00
2018	\$1,222,763.00	\$452,344.00	\$1,675,107.00	\$1,078,758.00
2017	\$1,164,536.00	\$433,395.00	\$1,597,931.00	\$1,047,339.00
2016	\$1,188,303.00	\$444,932.00	\$1,633,235.00	\$1,016,835.00
2015	\$1,060,985.00	\$399,621.00	\$1,460,606.00	\$987,219.00
2014	\$733,902.00	\$853,361.00	\$1,587,263.00	\$958,466.00
2013	\$733,901.00	\$768,445.00	\$1,502,346.00	\$930,551.00
2012	\$853,374.00	\$560,909.00	\$1,414,283.00	\$903,448.00
2011	\$853,374.00	\$560,909.00	\$1,414,283.00	\$877,135.00
2010	\$1,053,548.00	\$495,134.00	\$1,548,682.00	\$851,588.00
2009	\$1,239,469.00	\$1,010,479.00	\$2,249,948.00	\$826,785.00
2008	\$1,180,446.00	\$1,041,731.00	\$2,222,177.00	\$802,705.00
2007	\$1,053,969.00	\$930,116.00	\$1,984,085.00	\$779,326.00
2006	\$747,496.00	\$659,657.00	\$1,407,153.00	\$756,628.00
2005	\$692,126.00	\$610,761.00	\$1,302,887.00	\$734,591.00
2004	\$617,970.00	\$455,792.00	\$1,073,762.00	\$713,196.00
2003	\$577,146.00	\$274,919.00	\$852,065.00	\$658,945.00

Sales Date	Instrument ID	Sale Amount
October 16, 2013	201308785	\$1,742,250.00

<b>Tax Year</b>	<b>Total Billed</b>	<b>Interest</b>	<b>Discount</b>	<b>Total Due</b>
<a href="#">2020</a>	\$13,771.06	\$0.00	\$-413.13	\$13,357.93
<a href="#">2019</a>	\$12,943.54	\$0.00	\$0.00	\$0.00
<a href="#">2018</a>	\$12,264.51	\$0.00	\$0.00	\$0.00
<a href="#">2017</a>	\$11,787.61	\$0.00	\$0.00	\$0.00
<a href="#">2016</a>	\$10,138.25	\$0.00	\$0.00	\$0.00
<a href="#">2015</a>	\$9,733.10	\$0.00	\$0.00	\$0.00
<a href="#">2014</a>	\$9,418.75	\$0.00	\$0.00	\$0.00
<a href="#">2013</a>	\$9,140.73	\$0.00	\$0.00	\$0.00
<a href="#">2012</a>	\$9,280.20	\$0.00	\$0.00	\$0.00
<a href="#">2011</a>	\$9,202.04	\$0.00	\$0.00	\$0.00
<a href="#">2010</a>	\$8,866.38	\$0.00	\$0.00	\$0.00
<a href="#">2009</a>	\$8,690.75	\$0.00	\$0.00	\$0.00
<a href="#">2008</a>	\$8,410.03	\$0.00	\$0.00	\$0.00
<a href="#">2007</a>	\$8,202.73	\$0.00	\$0.00	\$0.00
<a href="#">2006</a>	\$7,999.08	\$0.00	\$0.00	\$0.00
<a href="#">2005</a>	\$7,719.89	\$0.00	\$0.00	\$0.00
2004	\$7,300.21	\$0.00	\$0.00	\$0.00
2003	\$6,683.36	\$0.00	\$0.00	\$0.00

[View Your Current Statement](#)

## Total Taxes Due as of November 5, 2020

Current Year Due	\$13,357.93
Past Year Due	\$0.00
<b>Total Due</b>	<b>\$13,357.93</b>

By clicking "Pay Your Bill" below, you agree that you have read our [Important Notes](#) regarding fees.

[Pay Your Bill](#)

<b>Tax Year</b>	<b>Receipt No</b>	<b>Date Posted</b>	<b>Amount Paid</b>
2019	614212	November 14, 2019	\$12,555.23
2018	593526	November 13, 2018	\$11,896.57
2017	575049	November 14, 2017	\$11,433.98
2016	554657	November 15, 2016	\$9,834.10
2015	532914	November 13, 2015	\$9,441.11
2014	509908	November 12, 2014	\$9,136.19
2013	481136	October 21, 2013	\$8,866.51
2012	463015	November 13, 2012	\$9,001.79
2011	442350	November 15, 2011	\$8,925.98
2010	415956	November 15, 2010	\$8,600.39
2009	390392	November 13, 2009	\$8,430.03
2008	366012	November 13, 2008	\$8,157.73
2007	339199	November 15, 2007	\$7,956.65
2006	308461	November 15, 2006	\$7,759.11
2005	275087	November 15, 2005	\$7,488.29
2004	236816	November 15, 2004	\$7,081.20
2003	195728	November 15, 2003	\$6,482.86

 [Annual Appraisal Report](#)

 [Current Statement](#)

©2020 Clatsop County, Oregon

Data accurate as of November 5, 2020 02:20PM Every effort has been made to offer the most current and correct information possible on these pages. The information included on these pages has been compiled by County staff from a variety of sources, and is subject to change without notice. Clatsop County makes no warranties or representations whatsoever regarding the quality, content, completeness, accuracy or adequacy of such information and data. Clatsop County reserves the right to make changes at any time without notice. Original records may differ from the information on these pages. Interest and discounts, if available, may not be accurately reflected here. Verification of information on source documents is recommended. By using this application, you assume all risks arising out of or associated with access to these pages, including but not limited to risks of damage to your computer, peripherals, software and data from any virus, software, file or other cause associated with access to this application. Clatsop County shall not be liable for any damages whatsoever arising out of any cause relating to use of this application, including but not limited to mistakes, omissions, deletions, errors, or defects in any information contained in these pages, or any failure to receive or delay in receiving information.

# 1766 S Hemlock St, Cannon Beach OR

Account 6322



[Property Details](#) [Improvements](#) [Assessments](#) [Sales History](#) [Taxes](#) [Payments](#) [Documents](#)

## General Information

- Property Address 1766 S Hemlock St, Cannon Beach OR
- Legal Description POR PARCEL 2 PARTITION PLAT 1998-009 LYING E OF THE ZONE LINE '02 Incl TL 602 (property W of the zone li)
- Account ID 6322
- Tax Map Key [51030DD00600](#)
- Size in Acres 0.77
- Property Status Active
- Property Type Real Property  
Residential  
Improved Residential Land

## Owner Information

Owner Name Musser Peter M  
Musser Tamara H

Mailing Address 145 39th Ave E  
Seattle WA 98112-5016

→ [Request Change of Address](#)

→ [Sign up for e-Statements](#)

Year Built	Sq Ft	Type	Stories
1999	2965	Single Family	2.0

Type	Sq Ft	Bedrooms	Bathrooms
First Floor	1357	0	1
Second Floor	1608	3	2.5

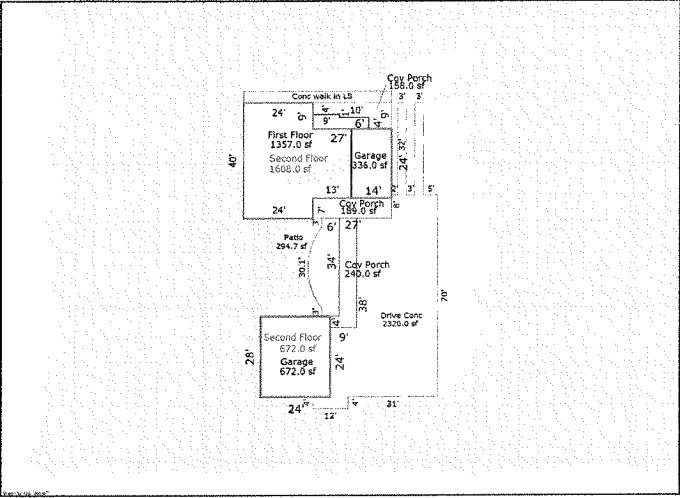

Year	Land Value	Improvements Value	Real Market Value	Assessed Value
2020	\$1,599,661.00	\$1,200,828.00	\$2,800,489.00	\$1,427,272.00
2019	\$1,583,823.00	\$1,196,420.00	\$2,780,243.00	\$1,385,702.00
2018	\$1,494,172.00	\$1,135,883.00	\$2,630,055.00	\$1,345,342.00
2017	\$1,423,021.00	\$1,088,516.00	\$2,511,537.00	\$1,306,158.00
2016	\$1,452,063.00	\$1,117,712.00	\$2,569,775.00	\$1,268,116.00
2015	\$1,296,485.00	\$1,004,083.00	\$2,300,568.00	\$1,231,182.00
2014	\$953,812.00	\$1,936,297.00	\$2,890,109.00	\$1,195,324.00
2013	\$953,812.00	\$1,801,696.00	\$2,755,508.00	\$1,160,510.00
2012	\$1,094,367.00	\$1,315,107.00	\$2,409,474.00	\$1,126,709.00
2011	\$1,094,367.00	\$905,431.00	\$1,999,798.00	\$1,093,893.00
2010	\$1,351,069.00	\$784,301.00	\$2,135,370.00	\$1,062,033.00
2009	\$1,589,494.00	\$1,600,616.00	\$3,190,110.00	\$1,031,101.00
2008	\$1,513,804.00	\$1,650,119.00	\$3,163,923.00	\$1,001,070.00
2007	\$1,351,610.00	\$1,473,320.00	\$2,824,930.00	\$971,913.00
2006	\$958,588.00	\$1,044,908.00	\$2,003,496.00	\$943,606.00
2005	\$887,577.00	\$967,957.00	\$1,855,534.00	\$916,123.00
2004	\$792,480.00	\$722,356.00	\$1,514,836.00	\$889,441.00
2003	\$769,399.00	\$484,803.00	\$1,254,202.00	\$863,536.00
2002	\$699,454.00	\$421,568.00	\$1,121,022.00	\$838,385.00
2001	\$659,863.00	\$345,548.00	\$1,005,411.00	\$813,967.00
2000	\$659,863.00	\$658,731.00	\$1,318,594.00	\$880,920.00
1999	\$680,272.00	\$173,689.00	\$853,961.00	\$507,327.00

Sales Date	Instrument ID	Sale Amount
August 30, 2011	201106623	\$2,875,000.00

<b>Tax Year</b>	<b>Total Billed</b>	<b>Interest</b>	<b>Total Due</b>
<a href="#">2020</a>	\$17,174.21	\$0.00	\$0.00
<a href="#">2019</a>	\$16,142.20	\$0.00	\$0.00
<a href="#">2018</a>	\$15,295.33	\$0.00	\$0.00
<a href="#">2017</a>	\$14,700.55	\$0.00	\$0.00
<a href="#">2016</a>	\$12,643.63	\$0.00	\$0.00
<a href="#">2015</a>	\$12,138.37	\$0.00	\$0.00
<a href="#">2014</a>	\$11,746.33	\$0.00	\$0.00
<a href="#">2013</a>	\$11,399.59	\$0.00	\$0.00
<a href="#">2012</a>	\$11,573.56	\$0.00	\$0.00
<a href="#">2011</a>	\$11,476.04	\$0.00	\$0.00
<a href="#">2010</a>	\$11,057.46	\$0.00	\$0.00
<a href="#">2009</a>	\$10,838.42	\$0.00	\$0.00
<a href="#">2008</a>	\$10,488.31	\$0.00	\$0.00
<a href="#">2007</a>	\$10,229.77	\$0.00	\$0.00
<a href="#">2006</a>	\$9,975.80	\$0.00	\$0.00
<a href="#">2005</a>	\$9,627.65	\$0.00	\$0.00
2004	\$9,104.23	\$0.00	\$0.00
2003	\$8,758.41	\$0.00	\$0.00
2002	\$8,497.46	\$0.00	\$0.00
2001	\$8,508.64	\$0.00	\$0.00
2000	\$8,557.49	\$0.00	\$0.00
1999	\$5,161.24	\$0.00	\$0.00
1998	\$2,481.54	\$0.00	\$0.00

[View Your Current Statement](#)

### Total Taxes Due as of November 5, 2020

Current Year Due	\$0.00
Past Year Due	\$0.00
<b>Total Due</b>	<b>\$0.00</b>

By clicking "Pay Your Bill" below, you agree that you have read our [Important Notes](#) regarding fees.

[Pay Your Bill](#)



<b>Tax Year</b>	<b>Receipt No</b>	<b>Date Posted</b>	<b>Amount Paid</b>
2020	626740	October 28, 2020	\$16,658.98
2019	611692	November 7, 2019	\$15,657.93
2018	592160	November 6, 2018	\$14,836.47
2017	575143	November 14, 2017	\$14,259.53
2016	552075	November 7, 2016	\$12,264.32
2015	530588	November 6, 2015	\$11,774.22
2014	506750	October 27, 2014	\$11,393.94
2013	482715	November 1, 2013	\$11,057.60
2012	459414	October 25, 2012	\$11,226.35
2011	436172	October 26, 2011	\$11,131.76
2010	428368	May 31, 2011	\$7,617.33
2010	418151	November 15, 2010	\$3,685.82
2009	392563	November 15, 2009	\$10,513.27
2009	393353	November 15, 2009	\$10,513.27
2008	380641	June 15, 2009	\$7,225.26
2008	369203	November 17, 2008	\$3,496.10
2007	343184	November 15, 2007	\$9,922.88
2006	315122	December 31, 2006	\$6,650.53
2006	312410	November 15, 2006	\$3,325.27
2005	278726	November 15, 2005	\$9,338.82
2004	238731	November 15, 2004	\$8,831.10
2003	198421	November 15, 2003	\$8,495.66
2002	154934	November 6, 2002	\$8,242.54
2001	130133	November 15, 2001	\$8,253.38
2000	106086	April 6, 2001	\$999.89
2000	106004	April 5, 2001	\$981.74
2000	106005	November 15, 2000	\$9,253.05
2000	91542	November 15, 2000	\$9,253.05
1999	54161	November 9, 1999	\$5,006.40
1998	29730	May 13, 1999	\$827.18
1998	29729	February 16, 1999	\$827.18

<b>Tax Year</b>	<b>Receipt No</b>	<b>Date Posted</b>	<b>Amount Paid</b>
1998	29728	November 19, 1998	\$827.18

 [Annual Appraisal Report](#)

 [Current Statement](#)

©2020 Clatsop County, Oregon

Data accurate as of November 5, 2020 02:16PM Every effort has been made to offer the most current and correct information possible on these pages. The information included on these pages has been compiled by County staff from a variety of sources, and is subject to change without notice. Clatsop County makes no warranties or representations whatsoever regarding the quality, content, completeness, accuracy or adequacy of such information and data. Clatsop County reserves the right to make changes at any time without notice. Original records may differ from the information on these pages. Interest and discounts, if available, may not be accurately reflected here. Verification of information on source documents is recommended. By using this application, you assume all risks arising out of or associated with access to these pages, including but not limited to risks of damage to your computer, peripherals, software and data from any virus, software, file or other cause associated with access to this application. Clatsop County shall not be liable for any damages whatsoever arising out of any cause relating to use of this application, including but not limited to mistakes, omissions, deletions, errors, or defects in any information contained in these pages, or any failure to receive or delay in receiving information.

# 1698 Forest Lawn Rd, Cannon Beach OR

Account 51330



[Property Details](#)

[Improvements](#)

[Assessments](#)

[Sales History](#)

[Taxes](#)

[Payments](#)

[Documents](#)

## General Information

Property Address 1698 Forest Lawn Rd, Cannon Beach OR

Account ID 51330

Tax Map Key [51030DD00200](#)

Size in Acres 0.44

Property Status Active

Property Type Real Property  
Residential  
Improved Residential Land

## Owner Information

Owner Name Weed Steven Bruce  
McCauley Marie

Mailing Address 11601 Holmes Point Dr NE  
Kirkland WA 98034

→ [Request Change of Address](#)

→ [Sign up for e-Statements](#)

Tear down  
Bought in 2011 for 750K  
Sold in 2018 for 3,075,000  
3920 sq. ft. home.

Year Built	Sq Ft	Type	Stories
2011	3920	Single Family	2.0

Type	Sq Ft	Bedrooms	Bathrooms
Basement	1012		1
First Floor	1322	0	1.5
Second Floor	1586	3	2

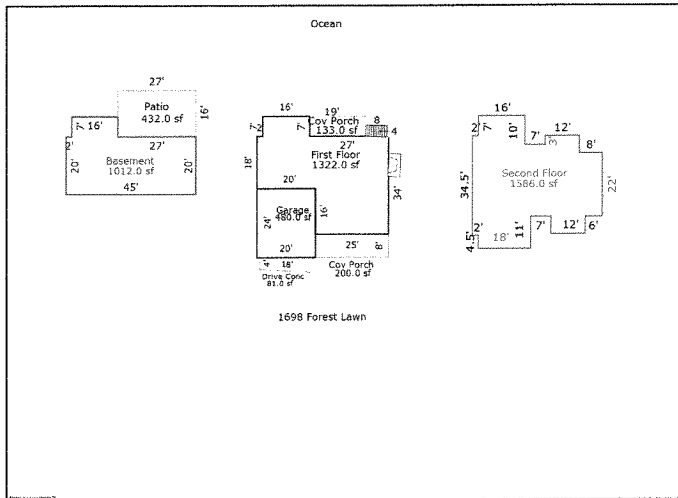

Year	Land Value	Improvements Value	Real Market Value	Assessed Value
2020	\$1,305,389.00	\$844,282.00	\$2,149,671.00	\$1,240,110.00
2019	\$1,292,464.00	\$840,485.00	\$2,132,949.00	\$1,203,991.00
2018	\$1,219,306.00	\$797,298.00	\$2,016,604.00	\$1,168,924.00
2017	\$1,161,244.00	\$677,766.00	\$1,839,010.00	\$1,134,879.00
2016	\$1,184,943.00	\$695,240.00	\$1,880,183.00	\$1,101,825.00
2015	\$1,057,985.00	\$623,939.00	\$1,681,924.00	\$1,069,734.00
2014	\$732,785.00	\$667,030.00	\$1,399,815.00	\$1,038,578.00
2013	\$732,785.00	\$616,627.00	\$1,349,412.00	\$1,008,329.00
2012	\$852,076.00	\$177,966.00	\$1,030,042.00	\$707,796.00
2011	\$852,076.00	\$182,094.00	\$1,034,170.00	\$695,285.00
2010	\$1,013,469.00	\$204,725.00	\$1,218,194.00	\$635,716.00
2009	\$1,192,317.00	\$417,808.00	\$1,610,125.00	\$617,201.00
2008	\$1,135,540.00	\$430,730.00	\$1,566,270.00	\$599,226.00
2007	\$1,013,874.00	\$384,580.00	\$1,398,454.00	\$581,773.00
2006	\$719,059.00	\$272,751.00	\$991,810.00	\$564,829.00
2005	\$665,791.00	\$251,899.00	\$917,690.00	\$548,378.00
2004	\$594,457.00	\$187,985.00	\$782,442.00	\$532,406.00
2003	\$577,143.00	\$126,165.00	\$703,308.00	\$516,900.00
2002	\$524,676.00	\$109,709.00	\$634,385.00	\$501,845.00
2001	\$494,978.00	\$89,926.00	\$584,904.00	\$487,229.00

Sales Date	Instrument ID	Sale Amount
May 31, 2018	201804154	\$3,075,000.00
January 1, 2011	201008411	\$750,000.00

<b>Tax Year</b>	<b>Total Billed</b>	<b>Interest</b>	<b>Discount</b>	<b>Total Due</b>
<a href="#">2020</a>	\$14,922.13	\$0.00	\$-447.66	\$14,474.47
<a href="#">2019</a>	\$14,025.41	\$0.00	\$0.00	\$0.00
<a href="#">2018</a>	\$13,289.63	\$0.00	\$0.00	\$0.00
<a href="#">2017</a>	\$12,772.83	\$0.00	\$0.00	\$0.00
<a href="#">2016</a>	\$10,985.64	\$0.00	\$0.00	\$0.00
<a href="#">2015</a>	\$10,546.62	\$0.00	\$0.00	\$0.00
<a href="#">2014</a>	\$10,205.99	\$0.00	\$0.00	\$0.00
<a href="#">2013</a>	\$9,904.72	\$0.00	\$0.00	\$0.00
<a href="#">2012</a>	\$7,270.46	\$0.00	\$0.00	\$0.00
<a href="#">2011</a>	\$7,294.25	\$0.00	\$0.00	\$0.00
<a href="#">2010</a>	\$6,618.83	\$0.00	\$0.00	\$0.00
<a href="#">2009</a>	\$6,487.73	\$0.00	\$0.00	\$0.00
<a href="#">2008</a>	\$6,278.14	\$0.00	\$0.00	\$0.00
<a href="#">2007</a>	\$6,123.39	\$0.00	\$0.00	\$0.00
<a href="#">2006</a>	\$5,971.37	\$0.00	\$0.00	\$0.00
<a href="#">2005</a>	\$5,762.95	\$0.00	\$0.00	\$0.00
2004	\$5,449.65	\$0.00	\$0.00	\$0.00
2003	\$5,242.68	\$0.00	\$0.00	\$0.00
2002	\$5,086.43	\$0.00	\$0.00	\$0.00
2001	\$5,093.15	\$0.00	\$0.00	\$0.00

[View Your Current Statement](#)

### Total Taxes Due as of November 5, 2020

Current Year Due	\$14,474.47
Past Year Due	\$0.00
<b>Total Due</b>	<b>\$14,474.47</b>

By clicking "Pay Your Bill" below, you agree that you have read our [important Notes](#) regarding fees.

[Pay Your Bill](#)

<b>Tax Year</b>	<b>Receipt No</b>	<b>Date Posted</b>	<b>Amount Paid</b>
2019	612859	November 12, 2019	\$13,604.65
2018	594487	November 13, 2018	\$12,890.94
2017	575143	November 14, 2017	\$12,389.65
2016	555828	November 15, 2016	\$10,656.07
2015	535430	November 16, 2015	\$10,230.22
2014	513615	November 17, 2014	\$9,899.81
2013	489307	November 15, 2013	\$9,607.58
2012	467221	November 15, 2012	\$7,052.35
2011	443308	November 15, 2011	\$7,075.42
2010	418151	November 15, 2010	\$6,420.27
2009	389394	November 12, 2009	\$6,293.10
2008	364653	November 10, 2008	\$6,089.80
2007	335316	November 9, 2007	\$5,939.69
2006	307410	November 15, 2006	\$5,792.23
2005	276133	November 15, 2005	\$4,977.60
2005	276135	November 15, 2005	\$612.46
2004	252108	May 12, 2005	\$199.04
2004	252111	May 12, 2005	\$1,617.52
2004	245249	February 9, 2005	\$199.02
2004	245250	February 9, 2005	\$1,617.52
2004	232296	November 12, 2004	\$1,617.53
2004	232279	November 12, 2004	\$199.02
2003	211596	May 12, 2004	\$191.47
2003	211597	May 12, 2004	\$1,556.09
2003	206464	February 11, 2004	\$1,556.09
2003	206465	February 11, 2004	\$191.47
2003	198422	November 15, 2003	\$1,556.09
2003	201499	November 15, 2003	\$1,556.09
2003	201499	November 15, 2003	\$1,747.56
2002	175513	May 8, 2003	\$185.76
2002	175514	May 8, 2003	\$1,509.71

<b>Tax Year</b>	<b>Receipt No</b>	<b>Date Posted</b>	<b>Amount Paid</b>
2002	170279	February 13, 2003	\$185.76
2002	170305	February 13, 2003	\$1,509.72
2002	157205	November 12, 2002	\$1,695.48
2001	140829	May 9, 2002	\$1,697.72
2001	135572	February 11, 2002	\$1,697.71
2001	130111	November 15, 2001	\$1,697.72

 [Annual Appraisal Report](#)

 [Current Statement](#)

©2020 Clatsop County, Oregon

Data accurate as of November 5, 2020 02:12PM Every effort has been made to offer the most current and correct information possible on these pages. The information included on these pages has been compiled by County staff from a variety of sources, and is subject to change without notice. Clatsop County makes no warranties or representations whatsoever regarding the quality, content, completeness, accuracy or adequacy of such information and data. Clatsop County reserves the right to make changes at any time without notice. Original records may differ from the information on these pages. Interest and discounts, if available, may not be accurately reflected here. Verification of information on source documents is recommended. By using this application, you assume all risks arising out of or associated with access to these pages, including but not limited to risks of damage to your computer, peripherals, software and data from any virus, software, file or other cause associated with access to this application. Clatsop County shall not be liable for any damages whatsoever arising out of any cause relating to use of this application, including but not limited to mistakes, omissions, deletions, errors, or defects in any information contained in these pages, or any failure to receive or delay in receiving information.

# 1688 Forest Lawn Rd, Cannon Beach OR

Account 51329

[Property Details](#)

[Improvements](#)

[Assessments](#)

[Sales History](#)

[Taxes](#)

[Payments](#)

[Documents](#)



## General Information

Property Address  1688 Forest Lawn Rd, Cannon Beach OR

Account ID  51329

Tax Map Key  [51030DD00100](#)

Size in Acres  0.35

Property Status ☒ Active

Property Type  Real Property  
Residential  
Improved Residential Land

## Owner Information

Owner Name  Tutmarc Michael  
Tutmarc Nancy

Mailing Address  3857 45th Ave NE  
Seattle WA 98105-5450

→ [Request Change of Address](#)

→ [Sign up for e-Statements](#)



Year	Land Value	Improvements Value	Real Market Value	Assessed Value
2020	\$1,277,010.00	\$613,870.00	\$1,890,880.00	\$880,566.00
2019	\$1,264,366.00	\$611,110.00	\$1,875,476.00	\$854,919.00
2018	\$1,192,798.00	\$579,709.00	\$1,772,507.00	\$830,019.00
2017	\$1,135,999.00	\$555,027.00	\$1,691,026.00	\$805,845.00
2016	\$1,159,183.00	\$569,338.00	\$1,728,521.00	\$782,375.00
2015	\$1,034,985.00	\$510,949.00	\$1,545,934.00	\$759,588.00
2014	\$635,068.00	\$485,872.00	\$1,120,940.00	\$737,465.00
2013	\$635,067.00	\$448,540.00	\$1,083,607.00	\$715,986.00
2012	\$738,451.00	\$327,402.00	\$1,065,853.00	\$695,133.00
2011	\$812,902.00	\$0.00	\$812,902.00	\$436,845.00
2010	\$1,003,583.00	\$0.00	\$1,003,583.00	\$496,415.00
2009	\$1,180,686.00	\$0.00	\$1,180,686.00	\$481,957.00
2008	\$1,124,463.00	\$0.00	\$1,124,463.00	\$467,920.00
2007	\$1,003,984.00	\$0.00	\$1,003,984.00	\$454,292.00
2006	\$712,045.00	\$0.00	\$712,045.00	\$441,061.00
2005	\$659,298.00	\$0.00	\$659,298.00	\$428,215.00
2004	\$588,659.00	\$0.00	\$588,659.00	\$415,743.00
2003	\$571,514.00	\$0.00	\$571,514.00	\$403,634.00
2002	\$519,559.00	\$0.00	\$519,559.00	\$391,878.00
2001	\$490,150.00	\$0.00	\$490,150.00	\$380,465.00

Sales Date	Instrument ID	Sale Amount
January 1, 2011	201008505	\$600,000.00

Tax Year	Total Billed	Interest	Discount	Total Due
<a href="#">2020</a>	\$10,595.77	\$0.00	\$-317.87	\$10,277.90
<a href="#">2019</a>	\$9,959.06	\$0.00	\$0.00	\$0.00
<a href="#">2018</a>	\$9,436.55	\$0.00	\$0.00	\$0.00
<a href="#">2017</a>	\$9,069.62	\$0.00	\$0.00	\$0.00
<a href="#">2016</a>	\$7,800.60	\$0.00	\$0.00	\$0.00
<a href="#">2015</a>	\$7,488.84	\$0.00	\$0.00	\$0.00
<a href="#">2014</a>	\$7,247.00	\$0.00	\$0.00	\$0.00
<a href="#">2013</a>	\$7,033.07	\$0.00	\$0.00	\$0.00
<a href="#">2012</a>	\$7,140.41	\$0.00	\$0.00	\$0.00
<a href="#">2011</a>	\$4,582.94	\$0.00	\$0.00	\$0.00
<a href="#">2010</a>	\$5,168.49	\$0.00	\$0.00	\$0.00
<a href="#">2009</a>	\$5,066.10	\$0.00	\$0.00	\$0.00
<a href="#">2008</a>	\$4,902.45	\$0.00	\$0.00	\$0.00
<a href="#">2007</a>	\$4,781.62	\$0.00	\$0.00	\$0.00
<a href="#">2006</a>	\$4,662.91	\$0.00	\$0.00	\$0.00
<a href="#">2005</a>	\$4,500.14	\$0.00	\$0.00	\$0.00
2004	\$4,255.49	\$0.00	\$0.00	\$0.00
2003	\$4,093.86	\$0.00	\$0.00	\$0.00
2002	\$3,971.87	\$0.00	\$0.00	\$0.00
2001	\$3,977.13	\$0.00	\$0.00	\$0.00

[View Your Current Statement](#)

### Total Taxes Due as of November 5, 2020 <sup>?</sup>

Current Year Due	\$10,277.90
Past Year Due	\$0.00
<b>Total Due</b>	<b>\$10,277.90</b>

By clicking "Pay Your Bill" below, you agree that you have read our [Important Notes](#) regarding fees.

[Pay Your Bill](#)

<b>Tax Year</b>	<b>Receipt No</b>	<b>Date Posted</b>	<b>Amount Paid</b>
2019	610184	November 1, 2019	\$9,660.29
2018	592184	November 6, 2018	\$9,153.45
2017	571226	November 3, 2017	\$8,797.53
2016	552336	November 8, 2016	\$7,566.58
2015	528371	October 26, 2015	\$7,264.17
2014	511298	November 14, 2014	\$7,029.59
2013	483489	November 5, 2013	\$6,822.08
2012	464194	November 14, 2012	\$6,926.20
2011	443241	November 15, 2011	\$4,445.45
2010	421051	January 13, 2011	\$1,722.83
2010	418383	November 15, 2010	\$3,376.75
2009	389394	November 12, 2009	\$4,914.12
2008	364653	November 10, 2008	\$4,755.38
2007	335314	November 9, 2007	\$4,638.17
2006	307410	November 15, 2006	\$4,523.02
2005	276135	November 15, 2005	\$1,152.49
2005	276137	November 15, 2005	\$3,212.65
2004	252108	May 12, 2005	\$1,418.49
2004	245249	February 9, 2005	\$1,418.50
2004	232279	November 12, 2004	\$1,418.50
2003	211596	May 12, 2004	\$1,364.62
2003	206465	February 11, 2004	\$1,364.62
2003	198422	November 15, 2003	\$1,556.09
2003	201499	November 15, 2003	\$1,364.62
2003	201499	November 15, 2003	\$1,556.09
2002	175513	May 8, 2003	\$1,323.95
2002	170279	February 13, 2003	\$1,323.96
2002	157205	November 12, 2002	\$1,323.96
2001	140829	May 9, 2002	\$1,325.71
2001	135572	February 11, 2002	\$1,325.71
2001	130111	November 15, 2001	\$1,325.71

## Annual Appraisal Report

## Current Statement

©2020 Clatsop County, Oregon

Data accurate as of November 5, 2020 02:09PM Every effort has been made to offer the most current and correct information possible on these pages. The information included on these pages has been compiled by County staff from a variety of sources, and is subject to change without notice. Clatsop County makes no warranties or representations whatsoever regarding the quality, content, completeness, accuracy or adequacy of such information and data. Clatsop County reserves the right to make changes at any time without notice. Original records may differ from the information on these pages. Interest and discounts, if available, may not be accurately reflected here. Verification of information on source documents is recommended. By using this application, you assume all risks arising out of or associated with access to these pages, including but not limited to risks of damage to your computer, peripherals, software and data from any virus, software, file or other cause associated with access to this application. Clatsop County shall not be liable for any damages whatsoever arising out of any cause relating to use of this application, including but not limited to mistakes, omissions, deletions, errors, or defects in any information contained in these pages, or any failure to receive or delay in receiving information.

# 1680 Forest Lawn Rd, Cannon Beach OR

Account 51044

[Property Details](#)

[Improvements](#)

[Assessments](#)

[Sales History](#)

[Taxes](#)

[Payments](#)

[Documents](#)

## General Information

Property Address  1680 Forest Lawn Rd, Cannon Beach OR

Account ID  51044

Tax Map Key  [51030DA04700](#)

Size in Acres  0.44

Property Status ☒ Active

Property Type  Real Property  
Residential  
Improved Residential Land

## Owner Information

Owner Name  Alleva Fileno A  
Alleva Holly N

Mailing Address  28725 NE Tolt Hill Rd  
Carnation WA 98014

→ [Request Change of Address](#)

→ [Sign up for e-Statements](#)

Bought in 2015 for 1.1 million  
Tear down in  
2017(?)  
Rebuilt in 2018  
2957sq.

Year Built	Sq Ft	Type	Stories
2018	2957	Single Family	2.0

Type	Sq Ft	Bedrooms	Bathrooms
First Floor	1388		0.5
Second Floor	1569	4	3

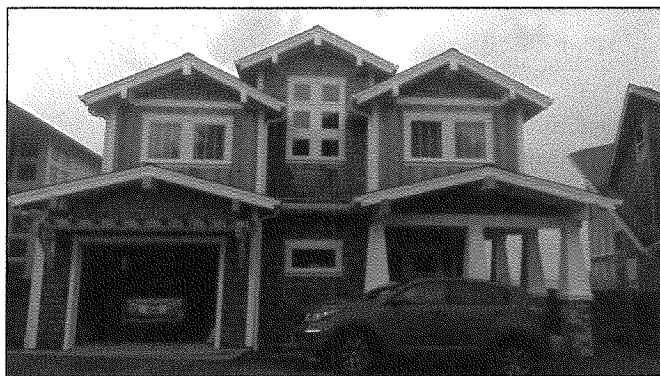
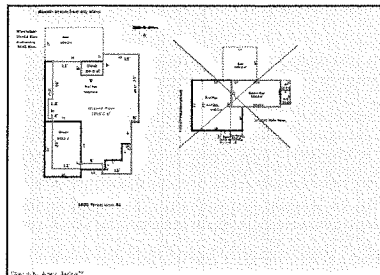

Year	Land Value	Improvements Value	Real Market Value	Assessed Value
2020	\$1,090,052.00	\$661,932.00	\$1,751,984.00	\$1,136,544.00
2019	\$1,079,259.00	\$658,495.00	\$1,737,754.00	\$1,103,442.00
2018	\$1,022,779.00	\$129,075.00	\$1,151,854.00	\$729,201.00
2017	\$974,075.00	\$172,077.00	\$1,146,152.00	\$743,346.00
2016	\$993,955.00	\$176,758.00	\$1,170,713.00	\$721,696.00
2015	\$887,460.00	\$158,884.00	\$1,046,344.00	\$700,677.00
2014	\$704,866.00	\$297,730.00	\$1,002,596.00	\$680,270.00
2013	\$704,866.00	\$278,914.00	\$983,780.00	\$660,457.00
2012	\$819,612.00	\$203,587.00	\$1,023,199.00	\$641,222.00
2011	\$819,612.00	\$203,587.00	\$1,023,199.00	\$622,547.00
2010	\$1,011,866.00	\$170,101.00	\$1,181,967.00	\$604,415.00
2009	\$1,190,431.00	\$347,146.00	\$1,537,577.00	\$586,811.00
2008	\$1,133,743.00	\$357,883.00	\$1,491,626.00	\$569,720.00
2007	\$1,012,271.00	\$319,538.00	\$1,331,809.00	\$553,127.00
2006	\$717,922.00	\$226,622.00	\$944,544.00	\$537,017.00
2005	\$664,739.00	\$209,955.00	\$874,694.00	\$521,377.00
2004	\$593,517.00	\$156,683.00	\$750,200.00	\$506,192.00
2003	\$576,231.00	\$105,157.00	\$681,388.00	\$491,450.00
2002	\$523,847.00	\$91,441.00	\$615,288.00	\$477,137.00
2001	\$494,196.00	\$47,314.00	\$541,510.00	\$437,805.00

Sales Date	Instrument ID	Sale Amount
January 20, 2015	201500791	\$1,100,000.00

<b>Tax Year</b>	<b>Total Billed</b>	<b>Interest</b>	<b>Total Due</b>
<a href="#">2020</a>	\$13,675.91	\$0.00	\$0.00
<a href="#">2019</a>	\$12,854.09	\$0.00	\$0.00
<a href="#">2018</a>	\$8,290.33	\$0.00	\$0.00
<a href="#">2017</a>	\$8,366.18	\$0.00	\$0.00
<a href="#">2016</a>	\$7,195.60	\$0.00	\$0.00
<a href="#">2015</a>	\$6,908.07	\$0.00	\$0.00
<a href="#">2014</a>	\$6,684.93	\$0.00	\$0.00
<a href="#">2013</a>	\$6,487.62	\$0.00	\$0.00
<a href="#">2012</a>	\$6,586.65	\$0.00	\$0.00
<a href="#">2011</a>	\$6,531.12	\$0.00	\$0.00
<a href="#">2010</a>	\$6,292.91	\$0.00	\$0.00
<a href="#">2009</a>	\$6,168.26	\$0.00	\$0.00
<a href="#">2008</a>	\$5,969.03	\$0.00	\$0.00
<a href="#">2007</a>	\$5,821.90	\$0.00	\$0.00
<a href="#">2006</a>	\$5,677.34	\$0.00	\$0.00
<a href="#">2005</a>	\$5,479.21	\$0.00	\$0.00
2004	\$5,181.32	\$0.00	\$0.00
2003	\$4,984.53	\$0.00	\$0.00
2002	\$4,836.02	\$0.00	\$0.00
2001	\$4,576.50	\$0.00	\$0.00

[View Your Current Statement](#)

### Total Taxes Due as of November 5, 2020

Current Year Due	\$0.00
Past Year Due	\$0.00
<b>Total Due</b>	<b>\$0.00</b>

By clicking "Pay Your Bill" below, you agree that you have read our [Important Notes](#) regarding fees.

[Pay Your Bill](#)

<b>Tax Year</b>	<b>Receipt No</b>	<b>Date Posted</b>	<b>Amount Paid</b>
2020	625582	October 19, 2020	\$13,265.63
2019	607823	October 18, 2019	\$12,468.47
2018	595442	November 15, 2018	\$8,041.62
2017	579003	December 11, 2017	\$96.65
2017	577166	November 19, 2017	\$8,500.00
2016	550318	October 30, 2016	\$6,979.73
2015	529702	November 2, 2015	\$6,700.83
2014	509027	November 7, 2014	\$6,484.38
2013	483489	November 5, 2013	\$6,292.99
2012	460719	November 2, 2012	\$6,389.05
2011	436006	October 26, 2011	\$6,335.19
2010	412748	November 4, 2010	\$6,104.12
2009	388685	November 10, 2009	\$5,983.21
2008	361553	October 20, 2008	\$5,789.96
2007	334080	November 7, 2007	\$5,647.24
2006	303120	November 8, 2006	\$5,507.02
2005	286739	April 17, 2006	\$1,826.41
2005	283830	February 13, 2006	\$1,826.40
2005	271819	November 10, 2005	\$1,826.40
2004	232222	November 10, 2004	\$5,025.88
2003	196378	November 17, 2003	\$4,834.99
2002	158408	November 14, 2002	\$4,690.94
2001	133495	January 8, 2002	\$0.01
2001	128519	November 15, 2001	\$4,439.21

 [Annual Appraisal Report](#)

 [Current Statement](#)

©2020 Clatsop County, Oregon

Data accurate as of November 5, 2020 02:03PM Every effort has been made to offer the most current and correct information possible on these pages. The information included on these pages has been compiled by County staff from a variety of sources, and is subject to change without notice. Clatsop County makes no warranties or representations whatsoever regarding the quality, content, completeness, accuracy or adequacy of such information and data. Clatsop County reserves the right to make changes at any time without notice. Original records may differ from the information on these pages. Interest and discounts, if available, may not be accurately reflected here. Verification of information on source documents is recommended. By using this application, you assume all risks arising out of or associated with access to these pages, including but not limited to risks of damage to your computer, peripherals, software and data from any virus, software, file or other cause associated with access to this application. Clatsop County shall not be liable for any damages whatsoever arising out of any cause relating to use of this application, including but not limited to mistakes, omissions, deletions, errors, or defects in any information contained in these pages, or any failure to receive or delay in receiving information.