



**CANNON BEACH COMMUNITY DEVELOPMENT**

163 E. GOWER ST.

PO Box 368

CANNON BEACH, OR 97110

## MEMORANDUM

**RE: Tree Removal Permit**

**2364 S. Hemlock St., Taxlot 51031AA05402**

July 20, 2023

A tree removal permit authorizing the removal of one Sitka Spruce that had been determined to be dead.

The application was submitted with a Tree Hazard Evaluation Form prepared by an ISA Certified Arborist as required by CBMC 17.70.030.

This removal application meets the criteria of CBMC 17.70.020(C) Permit Issuance - Criteria which states:

*C. Removal of a dead tree.*

Replacement of the removed trees is required as per CBMC 17.70.040(B)(2) Tree Replacement Policy which states:

The basic standard is that four trees should be maintained on a five thousand square foot lot. For larger lots the standard will be applied on a proportional basis, e.g., a seven thousand five hundred square foot lot would require maintenance of six trees. This standard is to be implemented as follows:

2. *Tree removal not in conjunction with construction:*

- a. *If after tree removal the site maintains the standard of at least four trees per five thousand square feet, no replacement is required.*
- b. *If after tree removal the site maintains the standard of at least four trees per five thousand square feet, the replanting of trees on a one-for-one basis may be required.*
- c. *A minimum density of less than four trees per five thousand square feet may be permitted where it is found that the remaining trees provide sufficient cover, immature trees (those less than six inches diameter) will mature to provide adequate cover, or there are no reasonable locations for new trees.*

Approved trees to be used for replanting are:

- Sitka spruce
- Western hemlock
- Douglas fir
- Western red cedar
- Red alder
- Mountain ash
- Big leaf maple
- Vine maple

This permit may be appealed to the Planning Commission by filing an appeal with the City Manager within 14 days of the date of this decision.

Sincerely,

A handwritten signature in black ink, appearing to be 'R. St. Clair', written in a cursive style.

Robert St. Clair  
Planner



## City of Cannon Beach Tree Removal Application

Please fill out this form completely. Please type or print.

**Applicant Name:** On behalf of TMCJ Pacific LLC - Terrence and Michelle Abrahams

**Mailing Address:** PO Box 863, CANNON BEACH, OR 97110-9800

**Phone:** 425 283 2309 **Email:** mich\_chool@hotmail.com

**Property Owner Name:** TMCJ Pacific LLC

**Mailing Address:** PO Box 863, CANNON BEACH, OR 97110-9800

**Phone:** 425 283 2309 **Email:** mich\_chool@hotmail.com

**Property Location:** 2364 S Hemlock, CANNON BEACH **Map/Tax Lot Number:** 51031AA05402

**The city shall issue a tree removal permit if one of the following criteria is met. Please circle the letter of the criteria that applies.**

These criteria require a Tree Removal Report from an International Society of Arboriculture (ISA) Certified Arborist:

- A. You are constructing a structure or development approved and allowed by pursuant to Cannon Beach Municipal Code 17.70.030, which involves any form of ground disturbance; including required vehicular and utility access. **SEE ATTACHMENT A – Removing Trees Because of Construction.**
- B. Removal of a tree for the health and vigor of surrounding trees.

These criteria require an ISA Tree Hazard Evaluation Form prepared by an ISA Certified Arborist:

- C. The tree presents a safety hazard, where:
  - 1. The condition or location of the tree presents either a foreseeable danger to public safety, or a foreseeable danger of property damage to an existing structure; and,
  - 2. Such hazard or danger cannot reasonably be alleviated by pruning or treatment of the tree.
- D. The tree was damaged by storm, fire or other injury, which cannot be saved by pruning.

You must submit a tree removal permit with a reason if:

- ☒ E. The tree is dead.
- F. Tree removal is necessary to provide solar access to a solar energy system where pruning will not provide adequate solar access:
  - 1. The city may require documentation that a device qualifies for Oregon Department of Energy Solar Tax Credit, or other incentive for installation of solar devices offered by a utility.
  - 2. No tree measuring more than 24 inches in diameter shall be removed for solar access.
- G. Tree removal is for landscaping purposes, subject to the following conditions:
  - 1. The tree cannot exceed 10 inches in diameter.
  - 2. A landscape plan for the affected area must be submitted and approved by the City.
  - 3. The landscape plan must incorporate replacement trees for the trees removed. The replacement trees must be at least six feet in height or have a two-inch caliper; and ,
  - 4. The City shall inspect the property one year after the approval of the permit to insure the landscape plan has been implemented.

**If your tree presents an immediate danger of collapse** and if such potential collapse represents a clear and present hazard to persons or property, **please contact the Community Development Director (CDD)**. If it is determined by the CDD that there is an immediate danger, then a tree removal permit is not required prior to tree removal. However, within seven days after the tree removal, the tree owner shall make application for an after-the-fact permit. Where a tree presents an immediate danger of collapse, a complete ISA Tree Hazard Evaluation Form prepared by a certified arborist is not required. Where a safety hazard exists, as defined by this subsection, the city may require the tree's removal. If the tree has not been removed after forty-eight hours, the city may remove the tree and charge the costs to the owner.



Attach a site plan showing the location and type of all trees on the property, including the trees to be removed. Indicate the location of replacement trees and the type. SEE ATTACHMENT B – Site Plan. Attach photos of the trees to be removed and mark the trees with ribbon.

Explain how the request meets one or more of the applicable criteria. Include the number and type of trees requested for removal. If appropriate, explain why pruning would not accomplish the same goal as tree removal.

Seeking to remove 1 dead tree of unknown type. The tree has not had any greenery for 2+ years, only moss is showing on the trunk and branches.  
There are 5 trees in the front yard (facing Gulcana), and 2 trees in the back yard (facing S Hemlock) - and we don't know the type of trees. Only that this 1 particular tree appears dead.  
We are seeking to prune the remaining trees to ensure they stay healthy.

Application fee: \$50.00 for 1-4 trees; \$100 for 5 or more trees

**Note:** The application fee is a **nonrefundable** fee that is due upon receipt of application, whether the removal request is approved or denied.

Applicant Signature [Signature] Date: June 27, 2023

If the applicant is other than the owner, the owner hereby grants permission for the applicant to act in their behalf.

Property Owner Signature: \_\_\_\_\_ Date: \_\_\_\_\_

Please attach the name, address, phone number and signature of any additional property owners.

I understand, as property owner, that I am responsible if an approved tree removal permit is violated in any way. As property owner, my signature or an authorized applicant's signature, allows any duly authorized employee of the City to enter upon all properties affected by this permit, for the purpose of follow-up inspection, observation or measurement.

Date: \_\_\_\_\_ Fee Paid: \$ \_\_\_\_\_ Receipt Number: \_\_\_\_\_ Permit #: \_\_\_\_\_

Application is:

\_\_\_\_\_ Approved \_\_\_\_\_ Denied

X Approved - Tree replacement required per Cannon Beach Municipal Code 17.70.040, Tree Replacement Policy.

\_\_\_\_\_ Approved with comments:

City of Cannon Beach  
Finance Department

JUL - 6 2023

PAID

By: [Signature] Robert St. Clair  
Planner Date: July 20, 2023

Decisions on the issuance of a tree removal permit may be appealed to the Planning Commission in accordance with Section 17.88.140 a, of the Municipal Code.



Unknown tree type

Unknown tree type

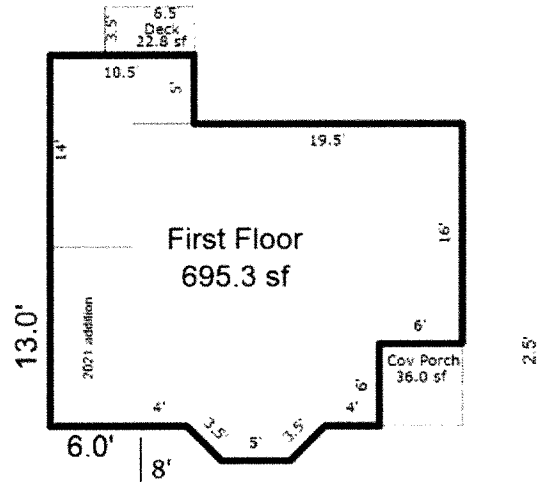

(X) Unknown type of dead tree. Moss only growing for 2+ years - no leaves, no greenery

Unknown tree type

Unknown tree type

Unknown tree type

Unknown tree



# A Photographic Guide to the Evaluation of Hazard Trees in Urban Areas

## TREE HAZARD EVALUATION FORM

2nd Edition

Site/Address: 2364 S. HEMLOCK CANNON BEACH

Map/Location: \_\_\_\_\_

Owner: public \_\_\_\_\_ private ☒ unknown \_\_\_\_\_ other \_\_\_\_\_

Date: 6-30-23 Arborist: BAUER ISA# PN0736

Arborist's Signature: [Signature]

### HAZARD RATING:

2 + 2 + 3 = 7  
 Failure Potential + Size of part + Target Rating = Hazard Rating  
☒ Immediate action needed  
☐ Needs further inspection  
☐ Dead tree

### TREE CHARACTERISTICS

Tree #: 1 Species: PICEA SITCHENSIS  
 DBH: 12 # of trunks: 1 Height: 40 Spread: ✓  
 Form: ☐ generally symmetric ☐ minor asymmetry ☐ major asymmetry ☐ stump sprout ☐ stag-headed  
 Crown Class: ☐ dominant ☐ co-dominant ☐ intermediate ☐ suppressed  
 Live crown ratio:    % Age Class: ☐ young ☐ semi-mature ☐ mature ☐ over-mature/senescent  
 Pruning History: ☐ crown cleaned ☐ excessively thinned ☐ topped ☐ crown raised ☐ pollarded ☐ crown reduced ☐ flush cuts ☐ cabled/braced  
☐ none ☐ multiple pruning events Approx. dates: \_\_\_\_\_  
 Special Value: ☐ specimen ☐ heritage/historic ☐ wildlife ☐ unusual ☐ street tree ☐ screen ☐ shade ☐ indigenous ☐ protected by gov. agency

### TREE HEALTH

DEAD TREE  
 Foliage Cover: ☐ normal ☐ chronic ☐ necrotic Episcormics? Y N  
 Foliage Density: ☐ normal ☐ sparse Leaf size: ☐ normal ☐ small  
 Annual shoot growth: ☐ excellent ☐ average ☐ poor Twig Dieback? Y N  
 Woundwood development: ☐ excellent ☐ average ☐ poor ☐ none  
 Vigor class: ☐ excellent ☐ average ☐ fair ☐ poor  
 Major pests/diseases: \_\_\_\_\_

### SITE CONDITIONS

Site Character: ☒ residence ☐ commercial ☐ industrial ☐ park ☐ open space ☐ natural ☐ woodland/forest  
 Landscape type: ☐ parkway ☐ raised bed ☐ container ☐ mound ☒ lawn ☐ shrub border ☐ wind break  
 Irrigation: ☐ none ☐ adequate ☐ inadequate ☐ excessive ☐ trunk wetted  
 Recent site disturbance? Y N ☐ construction ☐ soil disturbance ☐ grade change ☐ line clearing ☐ site clearing  
 % dripline paved: 0% 10-25% 25-50% 50-75% 75-100% Pavement lifted? Y N  
 % dripline w/ fill soil: 0% 10-25% 25-50% 50-75% 75-100%  
 % dripline grade lowered: 0% 10-25% 25-50% 50-75% 75-100%  
 Soil problems: ☐ drainage ☐ shallow ☐ compacted ☐ droughty ☐ saline ☐ alkaline ☐ acidic ☐ small volume ☐ disease center ☐ history of fail  
☐ clay ☐ expansive ☐ slope \_\_\_\_\_? aspect: \_\_\_\_\_  
 Obstructions: ☐ lights ☐ signage ☐ line-of-site ☐ view ☐ overhead lines ☐ underground utilities ☐ traffic ☐ adjacent veg. ☐ \_\_\_\_\_  
 Exposure to wind: ☐ single tree ☐ below canopy ☐ above canopy ☐ recently exposed ☐ windward, canopy edge ☐ area prone to windthrow  
 Prevailing wind direction: \_\_\_\_\_ Occurrence of snow/ice storms: ☐ never ☐ seldom ☐ regularly

### TARGET

Use Under Tree: ☒ building ☒ parking ☐ traffic ☐ pedestrian ☐ recreation ☐ landscape ☐ hardscape ☐ small features ☐ utility lines  
 Can target be moved? Y N ☒ Can use be restricted? Y N ☒  
 Occupancy: ☐ occasional use ☐ intermittent use ☒ frequent use ☐ constant use

## TREE DEFECTS

### ROOT DEFECTS:

Suspect root rot: ☒ Y ☐ N Mushroom/conk/bracket present: ☐ Y ☐ N ID: \_\_\_\_\_  
 Exposed roots: ☐ severe ☐ moderate ☐ low Undetermined: ☐ severe ☐ moderate ☐ low  
 Root pruned: \_\_\_\_\_ Root area affected: \_\_\_\_\_ % Buttress wounded: ☐ Y ☐ N When: \_\_\_\_\_  
 Restricted root area: ☐ severe ☐ moderate ☐ low Potential for root failure: ☐ severe ☐ moderate ☐ low  
 LEAN: SS deg. From vertical ☐ natural ☐ unnatural ☐ self-corrected Soil heaving: ☐ Y ☐ N  
 Decay in plane of lean: ☐ Y ☐ N Roots broken: ☐ Y ☐ N Soil cracking: ☐ Y ☐ N  
 Compounding factors: \_\_\_\_\_ Lean severity: ☐ severe ☐ moderate ☐ low

CROWN DEFECTS: Indicate presence of individual defects and rate their severity (s=severe, m=moderate, l=low)

DEFECT	ROOT CROWN	TRUNK	SCAFFOLDS	BRANCHES
Poor taper				
Bow, sweep				
Codominants/forks				
Multiple attachments				
Included bark				
Excessive end weight				
Cracks/splits				
Hangers				
Girdling				
Wounds/seam				
Decay				
Cavity				
Conks/mushrooms/bracket				
Bleeding/weep flow				
Loose/cracked bark				
Nesting hole/bee hive				
Deadwood/stubs				
Borers/termites/ants				
Cankers/galls/burns				
Previous failure				

## HAZARD RATING

Tree part most likely to fail: ENTIRE TREE  
 Inspection period: \_\_\_\_\_ annual \_\_\_\_\_ biannual \_\_\_\_\_ other \_\_\_\_\_  
 Failure Potential + Size of Part + Target Rating = Hazard Rating  
2 + 2 + 3 = 7  
 Failure potential: 1-low; 2-medium; 3-high; 4-severe  
 Size of part: 1 - <6" (15 cm); 2 - 6-18" (15-45 cm);  
 3 - 18-30" (45-75 cm); 4 - > 30" (75 cm)  
 Target rating: 1 - occasional use; 2 - intermittent use;  
 3 - frequent use; 4 - constant use

## HAZARD ABATEMENT

Prune: ☐ remove defective part ☐ reduce end weight ☐ crown clear ☐ thin ☐ raise canopy ☐ crown reduce ☐ restructure ☐ shape  
 Cable/brace: \_\_\_\_\_ Inspect further: ☐ root crown ☐ decay ☐ aerial ☐ monitor  
 Remove tree: ☒ Y ☐ N Replace? ☒ Y ☐ N Move Target: ☐ Y ☐ N Other: \_\_\_\_\_  
 Effect on adjacent trees: ☒ none ☐ evaluate  
 Notification: ☒ owner ☐ manager ☐ governing agency Date: \_\_\_\_\_

## COMMENTS

VERIFIED DEAD TREE. CAUSE NOT IDENTIFIED.  
 REMOVAL RECOMMENDED

*JB*

CONSULTING ARBORIST.